

Western Hills Garden (12/10/18)

Upper Trail

- 'Marie Beach'
- 'Shot Silk'*
- 'Champagne'*
- 'Itsukamachi'
- 'Egao Corkscrew'*
- White (unk)
- 'Scentsation'*
- 'Misty Moon'
- C. purpurea
- C. cuspidata
- 'Egao Corkscrew'
- 'White Doves Benton'
- C. sinensis (3)*

East-West Path

- 'Tulip Time'
- Red (unk)
- 'Tama No Ura'

Lower Path (West)

- C. granthamiana
- 'Peacock'
- 'Hana Fuki'
- Higo (unk)

Below Big House

- 'Night Rider'
- C. luchuensis
- C. yuhsienensis*

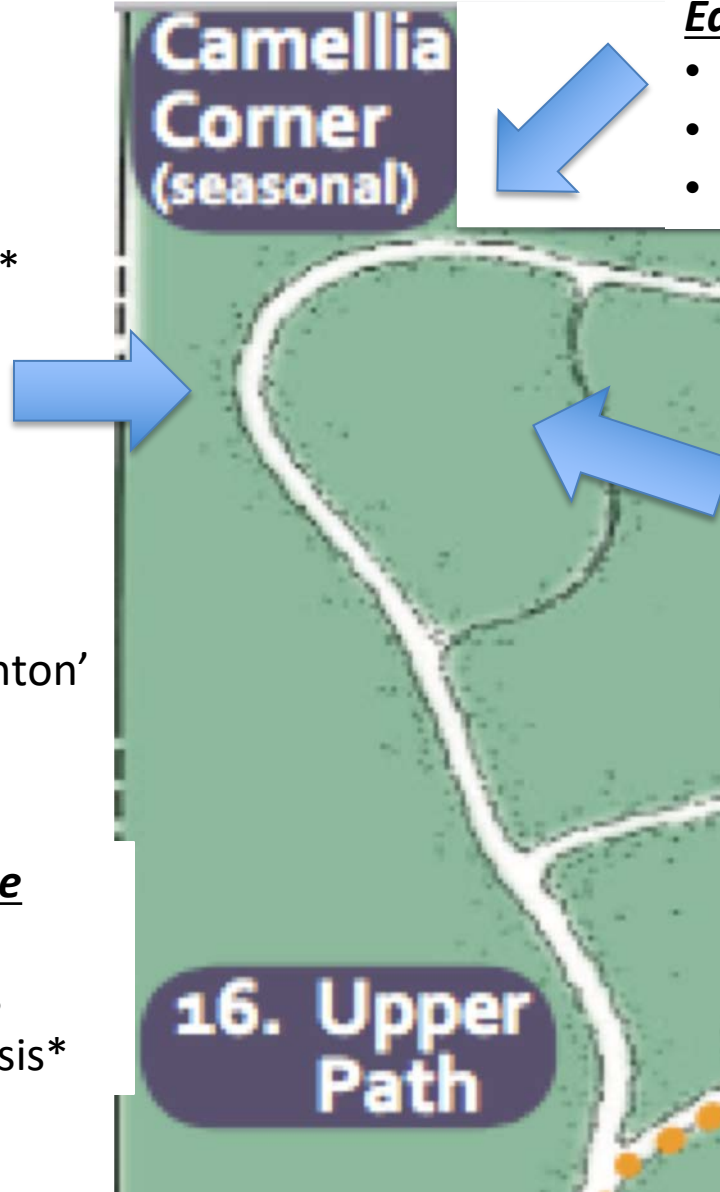
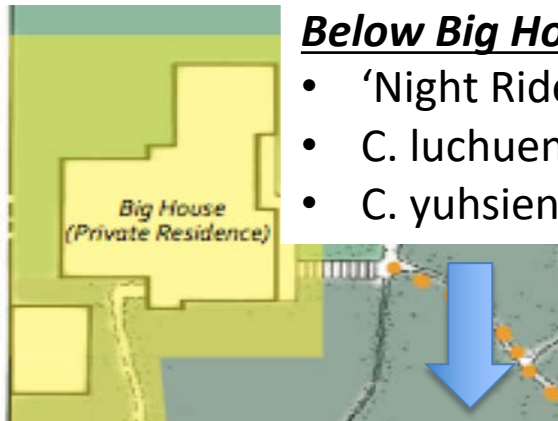

* Newly planted

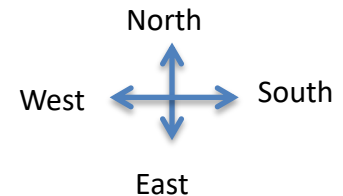

Camellias of Western Hills Garden (12/1/18)

Bottom of Garden

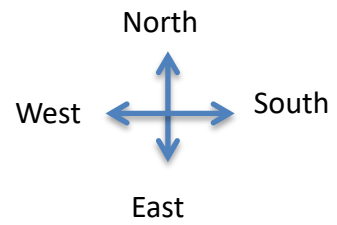

Big Pond

- 'Donation'
- C. sasanqua (unk)*
- 'Yuletide'
- C. lutchuensis
- C. transnokoensis

Circle

- 'Frank Houser'*
- C. oleifera*
- 'Snow Showers'
- C. transnokoensis

Stacie's

- C. transnokoensis

Bottom of Garden

- 'Oct Magic Orchid'*
- 'Frank Houser'*
- 'Pacific Star'*
- 'High Fragrance'*
- 'Golden World'*
- 'Silver Wave'*
- C. puniceiflora*
- C. reticulata
- 'Unryu Corkscrew'
- 'Yume'*
- 'Carousel'*
- 'Trophy'*
- 'Lucky Star'*
- 'Orchid Beauty'*
- 'Jean May'*

By Runnel

- 'Frank Houser'*
- 'Lady Laura'*

Folly

- 'Yume'(2)

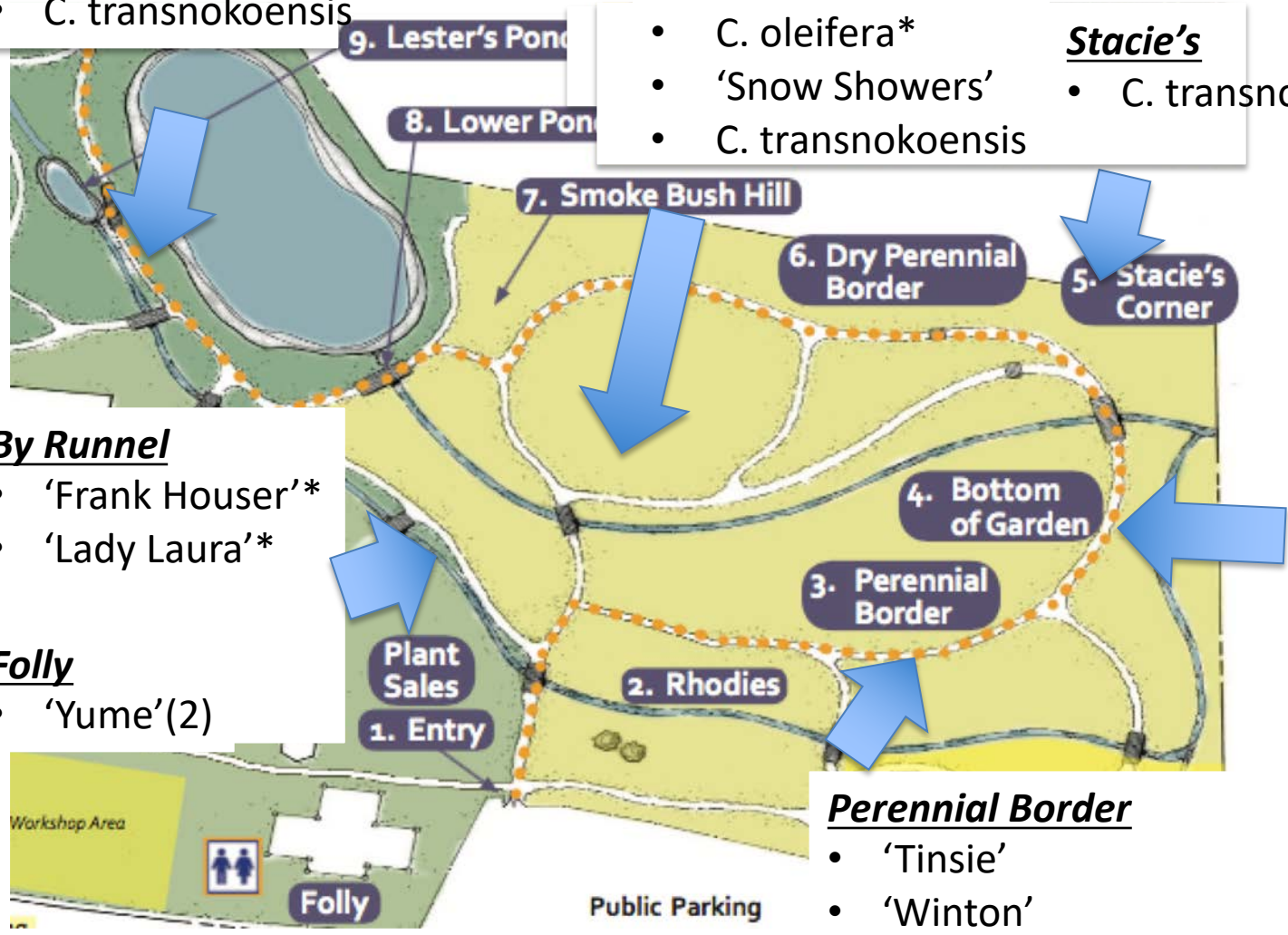

Perennial Border

- 'Tinsie'
- 'Winton'
- 'Frank Houser'*

* Newly planted